

DETAIL COAT(S) 2" MIN.  
EITHER SIDE OF JOINT  
(MIN. 30 DRY MILS)

ELASTOMERIC  
COATING SYSTEM

CRACK LESS  
THAN 1/16" WIDTH

STRUCTURAL SLAB

ROUTED & SEALED WITH  
URETHANE SEALANT OR  
FC7500/FC7960 COATING

CRACK GREATER  
THAN 1/16" WIDTH

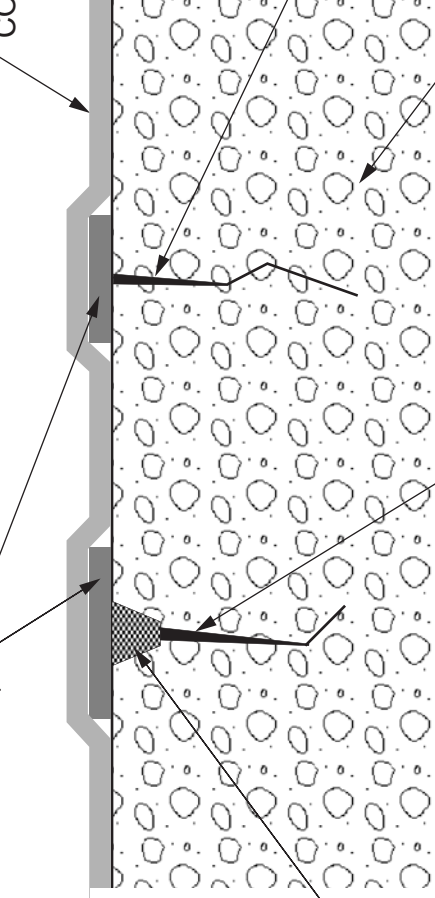

Notes:

This detail is utilized in the specification and design of surface applied waterproofing, in both new and retrofit applications. It is provided to show a generally recommended procedure for dealing with the condition shown. It will not and cannot provide a specific solution for every condition likely to be encountered in field application. Where field conditions differ, the use of applicable portions of the detail shown or its adaptation by an experienced and conscientious applicator should result in a quality project.



2728 Empire Central  
Dallas, Texas 75236  
(214) 353-1600  
www.neogard.com



Project:

Crack Detail

Drawn by:

D. Bigley

Scale:

NTS

Date:

07/18/07

Drawing/Index No.

WP-02